

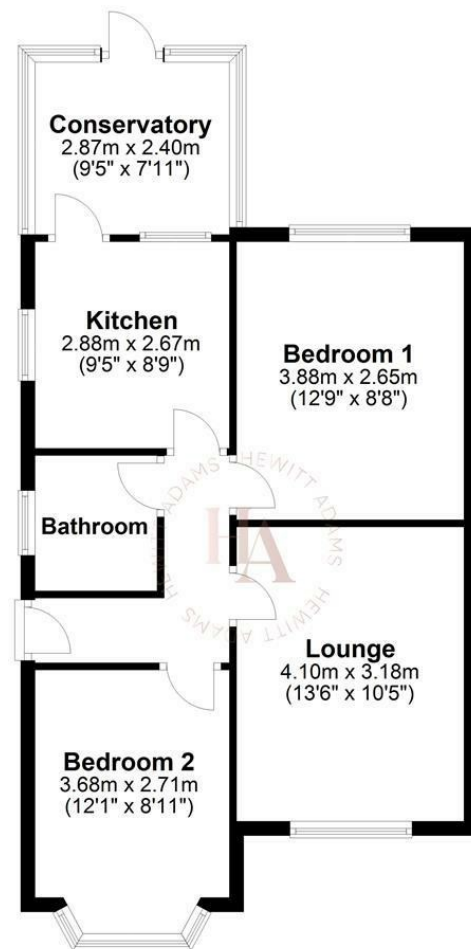

Ground Floor

Approx. 59.1 sq. metres (636.5 sq. feet)



Total area: approx. 59.1 sq. metres (636.5 sq. feet)
For illustration purposes only - not to scale

Shearman Close, Pensby, Wirral CH61 9PA

£230,000

2 Bedroom 1 Reception 1 Bathroom

Front Entrance

Into;

Hall

Radiator, power points

Lounge

10'5" x 13'5" (3.18 x 4.1)

Double glazed window, radiator, power points, fireplace

Kitchen

8'9" x 9'5" (2.67 x 2.88)

Wall and base units, spaces for white goods, inset sink, double glazed window, door into conservatory

Bathroom

Comprising bath, low level W.C, wash hand basin, double glazed window

Bedroom One

8'4" x 12'8" (2.55 x 3.88)

Double glazed window, radiator, power points, wardrobes

Bedroom Two

12'0" x 9'1" (3.68 x 2.77)

Conservatory

Overlooking the rear garden

EXTERNALLY

Front Aspect - Driveway with Garage

Rear Aspect - Large Corner Plot with a HUGE REAR garden comprising lawn, patio areas and flowerbeds

